

Nominal Pressure	PN16	
Shell Test (By Water)	2.4	Mpa
Seal Test (By Water)	1.76	
Seal Test (By Air)	0.6	

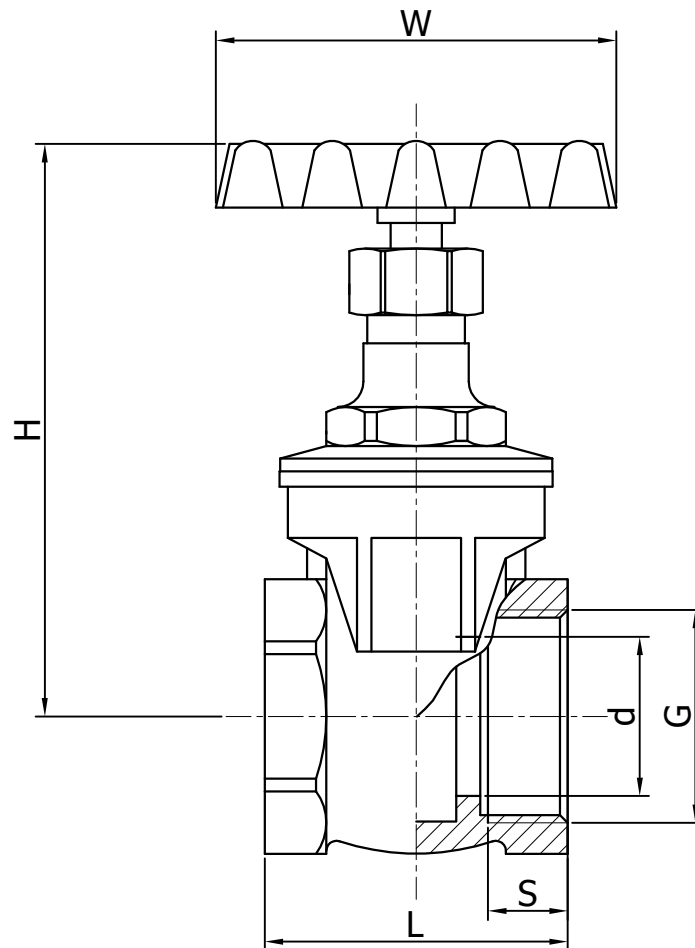

8	Handle wheel	Q235
7	Gland Nut	Brass (CW617N)
6	Stem Packing	PTFE
5	Stem	Brass (CW617N)
4	Seat	Brass (CW617N)
3	Disc	Brass (CW617N)
2	Bonnet	Brass (CW617N)
1	Body	Brass (CW617N)

NO.	Part Name	Material
-----	-----------	----------

**YONLIN**

BRASS  
GATE VALVE

PREPARED BY	XC.Wan	PN16	
APPROVED BY	Jack.Zhan		
DATE	15-Mar-17	MODEL	J11T-16T

YONGKANG LIANGGONG VALVE CO.,LTD

Unit: mm

SIZE	d	L	S	G	W	H
DN32	30	74	21.5	G1 1/4	78	122