



Know-how makes the difference



Brass Ball Valves



With DVC as your business partner, you are always guaranteed a wide and well sorted product range and a unique technical know-how

Product development is a key factor for DVC, ensuring you the best products at any time

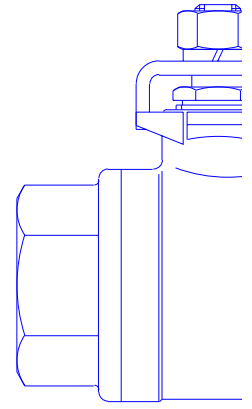

Brass
Long Service
Easy to Clean
Value for Money
Blow-out Proof Stem
Minimum Drop of Pressure

What is important to you, when you buy ball valves? What about: Long service? Brass? Easy to clean? Value for money? Blow-out proof stem? Minimum drop of pressure?

DVC brass ball valves are characterized by their blow out proof stem and minimum drop of pressure. The brass ball valves are available in a wide range of dimensions at competitive prices.

All these benefits you will get with DVC brass ball valves. It is your assurance for a prosperous business.

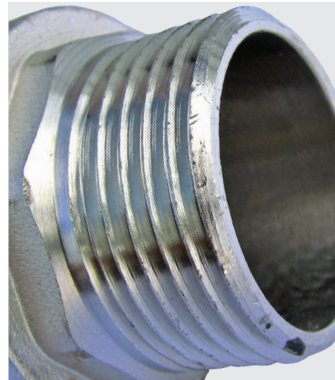
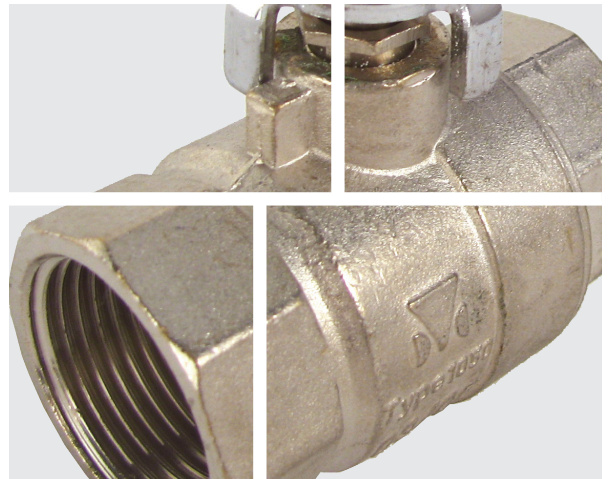

Brass Ball Valve with Steel
or Stainless Steel Handle
Type 1050
Female / female

Dimension
1/4" to 2" - 40 bar
2 1/2" to 4" - 25 bar



Benefits

- **Brass**
Type 1050 is made of nickel plated brass MS58, combined with PTFE seating materials.
- **Easy to clean**
Type 1050 is investment casted, thus having a smooth surface which is very easy to keep clean.
- **Blow-out proof stem**
Type 1050 has a blow-out proof stem, ensuring zero-leakage to the atmosphere, up to nominal pressure.
- **Minimum drop of pressure**
Type 1050 is full bore, thus providing a minimum drop of pressure through the valve.

Brass Ball Valve with Steel
or Stainless Steel Handle
Type 1050
Male / female

Dimension
1/4" to 2" - 40 bar



Benefits

- **Brass**
Type 1050 is made of nickel plated brass MS58, combined with PTFE seating materials.
- **Easy to clean**
Type 1050 is investment casted, thus having a smooth surface which is very easy to keep clean.
- **Blow-out proof stem**
Type 1050 has a blow-out proof stem, ensuring zero-leakage to the atmosphere, up to nominal pressure.
- **Minimum drop of pressure**
Type 1050 is full bore, thus providing a minimum drop of pressure through the valve.

Brass Ball Valve with Nickel
plated steel T-handle
Type 1050

Male / female
Female / female

Dimension
1/2" to 1" - 40 bar



Benefits

- **Brass**
Type 1050 is made of nickel plated brass MS58, combined with PTFE seating materials.
- **Easy to clean**
Type 1050 is investment casted, thus having a smooth surface which is very easy to keep clean.
- **Blow-out proof stem**
Type 1050 has a blow-out proof stem, ensuring zero-leakage to the atmosphere, up to nominal pressure.
- **Minimum drop of pressure**
Type 1050 is full bore, thus providing a minimum drop of pressure through the valve.
- **Mounting where space is limited**
Type 1050 can be mounted where space is the limitation, because of its nickel plated steel T-handle.

Structure and material

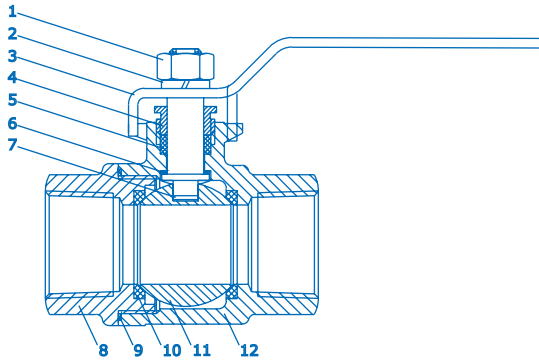

No.	Description	Material	Standard
1	Nut	(Stainless) steel	AISI 304
2	Nut washer	(Stainless) steel	AISI 304
3	Handle	(Stainless) steel with vinyl	AISI 304
4	Cap nut	Nickel Plated Brass	MS58
5	Stem packing	PTFE	
6	Thrust washer	PTFE	
7	Stem	Nickel Plated Brass	MS58
8	Threaded end	Nickel Plated Brass	MS58
9	Body gasket	PTFE	
10	Seat	PTFE	
11	Ball	Nickel Plated Brass	MS58
12	Body	Nickel Plated Brass	MS58

Dimensions (mm) and flow capacities

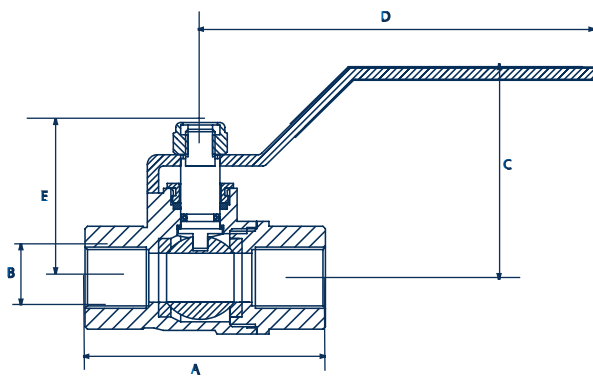

Pressure / temperature

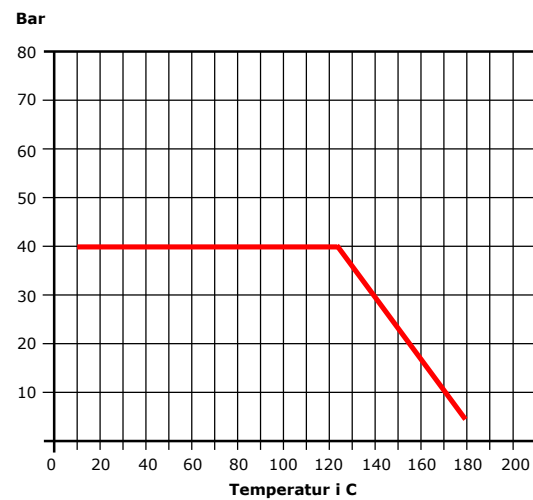

Dimension (inch)	A (mm)	B (mm)	C (mm)	D (mm)	E (mm)	Weight (kg)	* Kv-value 90°	Packing
1/4"	49,0	8,0	41,0	80,0	30,5	0,13	6,0	100
3/8"	51,0	10,0	42,0	80,0	30,5	0,14	9,3	100
1/2"	54,0	15,0	51,0	88,0	37,0	0,20	18,2	100
3/4"	60,0	20,0	58,4	100,7	42,4	0,30	39,8	60
1"	72,5	25,0	64,0	120,0	50,5	0,48	70,2	48
1 1/4"	79,5	32,0	64,0	133,8	59,0	0,72	120,0	32
1 1/2"	97,0	40,0	74,0	143,0	64,0	0,98	198,0	24
2"	114,0	50,0	83,0	144,0	74,0	1,52	290,0	8
2 1/2"	133,0	65,0	115,0	243,0	96,0	2,80	533,0	8
3"	144,0	80,0	115,0	247,0	113,0	4,20	850,0	6
4"	164,0	100,0	140,0	260,0	128,0	6,20	1350,0	4

* Kv-value rated flow coefficients (M3/h at 1 bar DP)

Structure and material

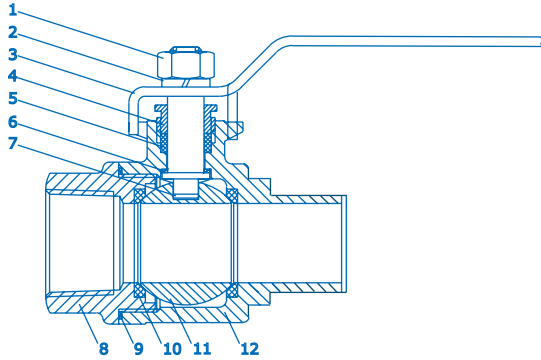

No.	Description	Material	Standard
1	Nut	(Stainless) steel	AISI 304
2	Nut washer	(Stainless) steel	AISI 304
3	Handle	(Stainless) steel with vinyl	AISI 304
4	Cap nut	Nickel Plated Brass	MS58
5	Stem packing	PTFE	
6	Thrust washer	PTFE	
7	Stem	Nickel Plated Brass	MS58
8	Threaded end	Nickel Plated Brass	MS58
9	Body gasket	PTFE	
10	Seat	PTFE	
11	Ball	Nickel Plated Brass	MS58
12	Body	Nickel Plated Brass	MS58

Dimensions (mm) and flow capacities

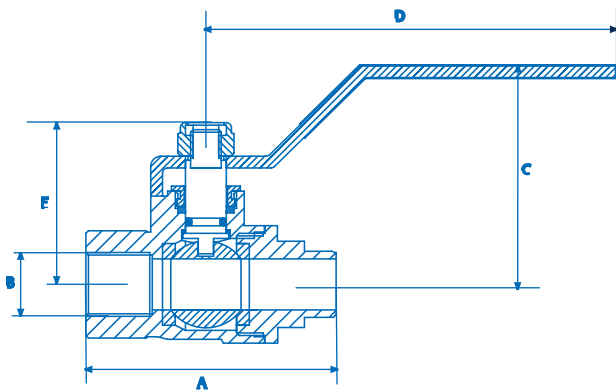

Pressure / temperature

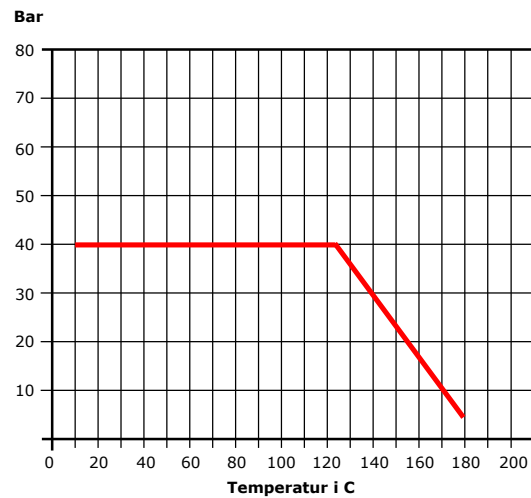

Dimension (inch)	A (mm)	B (mm)	C (mm)	D (mm)	E (mm)	Weight (kg)	Kv-value 90°	Packing
1/4"	52,0	8,0	43,0	80,4	31,7	0,13	6,0	100
3/8"	54,0	10,0	43,0	80,4	31,7	0,14	9,3	100
1/2"	60,0	15,0	49,5	92,5	37,0	0,20	18,2	100
3/4"	69,0	20,0	58,4	100,7	42,4	0,30	39,8	60
1"	77,5	25,0	69,5	120,0	50,5	0,48	70,2	48
1 1/4"	88,6	32,0	71,0	133,8	59,0	0,72	120,0	32
1 1/2"	100,0	40,0	74,0	143,0	64,0	0,98	198,0	24
2"	117,0	50,0	83,0	144,0	74,0	1,52	290,0	8

* Kv-valve rated flow coefficients (M3/h at 1 bar DP)

Structure and material

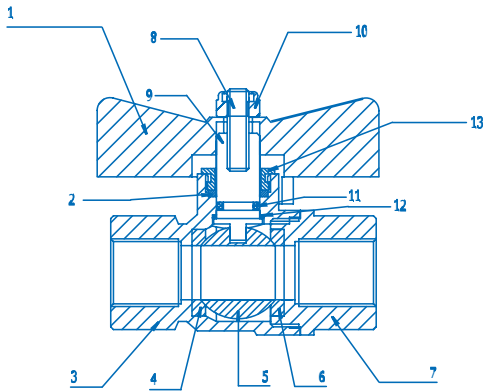

No.	Description	Material	Standard
1	T-handle	Nickel plated steel	
2	Upper Sealing	PTFE	
3	Body	Nickel Plated Brass	MS58
4	Seat	PTFE	
5	Ball	Nickel Plated Brass	MS58
6	Seat	PTFE	
7	Body	Nickel Plated Brass	MS58
8	Locking Nut	Nickel plated steel	
9	Stem	Nickel Plated Brass	MS58
10	O-ring	Viton	
11	Lower Sealing	PTFE	
12	Cap Nut	Nickel Plated Brass	MS58

Dimensions (mm) and flow capacities

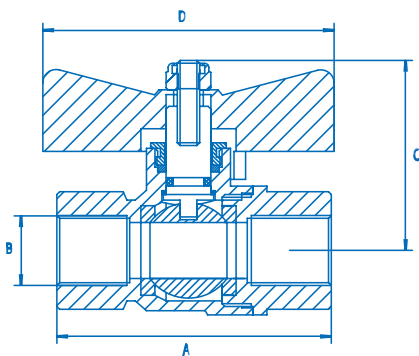

Dimension	A	B	C	D	Weight (kg)	Kv-valve 90°	Packing (pcs)
1/4"	49,0	8,0	38,0	53,0	0,13	6,0	100
3/8"	51,0	10,0	39,0	53,0	0,14	9,3	100
1/2"	54,0	15,0	42,0	53,0	0,20	18,2	100
3/4"	60,0	20,0	45,0	62,5	0,30	39,8	60
1"	72,5	25,0	56,0	62,5	0,48	70,2	48

* Kv-valve rated flow coefficients (M3/h at 1 bar DP)

Pressure / temperature

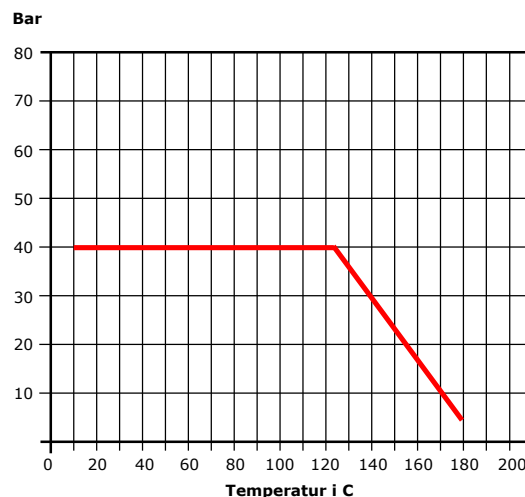



- Applied for DVGW certification

Installation guide

■ Installation

- 1.1 The valve is capable of tight shutoff with flow in either direction or dead-end, regardless of the position of the valve in the line.
- 1.2 To prevent damage to the seat and ball surface, the pipeline must be flushed free of dirt, burrs and welding residues, before installing the valve.
- 1.3 Maintain the valve or drive it in rotation only on the screwed side: by the 6-sides end with a plane wrench or an adjustable wrench

■ Use

- 2.1 Lifespan of the valve can be maximized, if the valve is used within the rated range, in accordance with pressure, temperature and corrosion data.

■ Operation

- 3.1 To open the valve, turn the handle 1/4 turn (90 degrees)
 - A. Valve in open position - the handle is parallel (in-line) with the valve or pipeline.
 - B. Valve in closed position - the handle is perpendicular (crossed) with the valve or pipeline.



Know-how makes the difference

Dansk Ventil Center A/S

Product Range

- Ball Valves
- Butterfly Valves Soft Seated
- Butterfly Valves Metal Seated
- Y-angle Globe Control Valves
- Thin Wafer Check Valves
- Pneumatic Actuators
- Electrical Actuators
- Brackets for Actuators
- Limit Switches
- Level Gauges - Reflex & Transparent

Dansk Ventil Center A/S is committed to meet the needs of customers with focus on environment and sustainability. Through continuous improvements, we strive to find new total cost ownership solutions in close cooperation with our customers.

Dansk Ventil Center is located in the northern part of Europe, in the heart of Denmark.

Visit us at www.dvcas.dk and learn more about Dansk Ventil Center and our products.



Dansk Ventil Center A/S

Ferrarivej 14
DK-7100 Vejle
Denmark

Tel.: +45 75 72 33 00
Fax: +45 75 72 75 15
E-mail: mail@dvcas.dk
Web: www.dvcas.dk

